



Automated Wardrobe Lift tm

Designer information and install tips



STORAGEMOTION^{INC.}

Determine Mounting Height

Not To Scale

Mounting height depends on customer reachable height plus vertical lifting distance

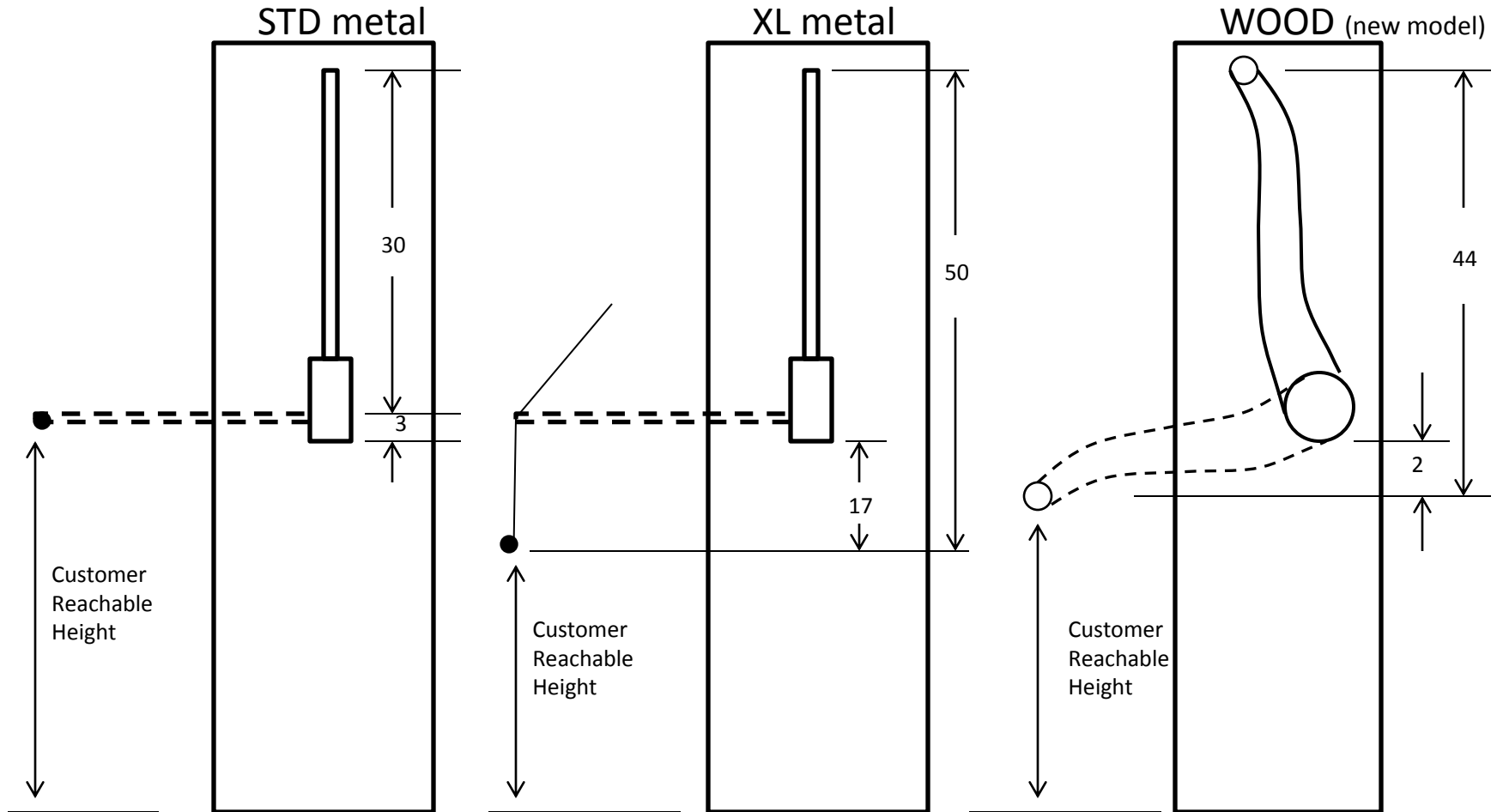

Request custom units if these mounting dimensions are not possible.

Extra vertical lifting distance is available.



STORAGE MOTION INC.

Different Mounting Designs

If shelf is below hanging clothes it can affect the length of the clothes that can be hung on the lift

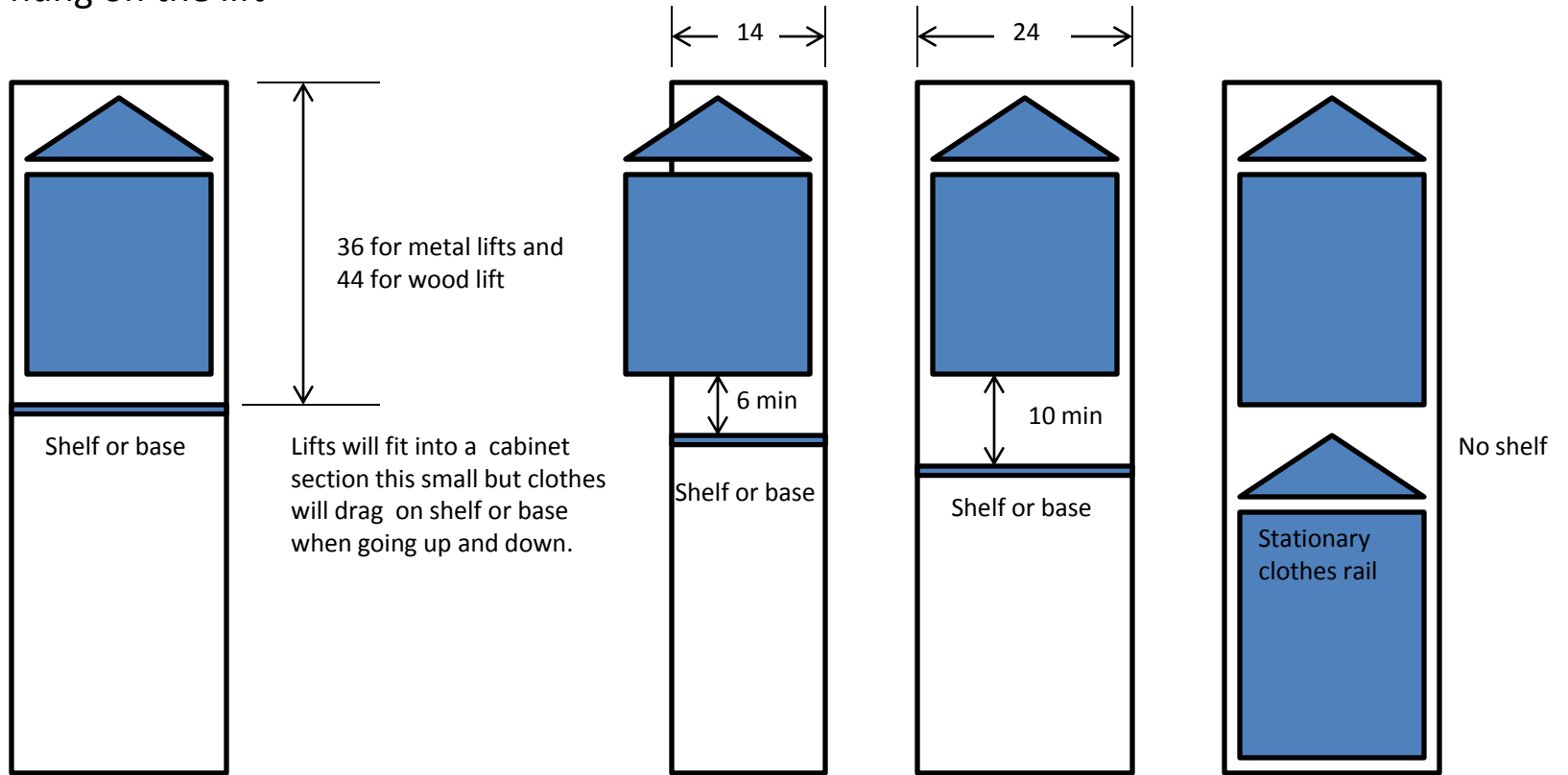

OK

RECOMMENDED



STORAGEMOTION^{INC.}

Determine Mounting Position

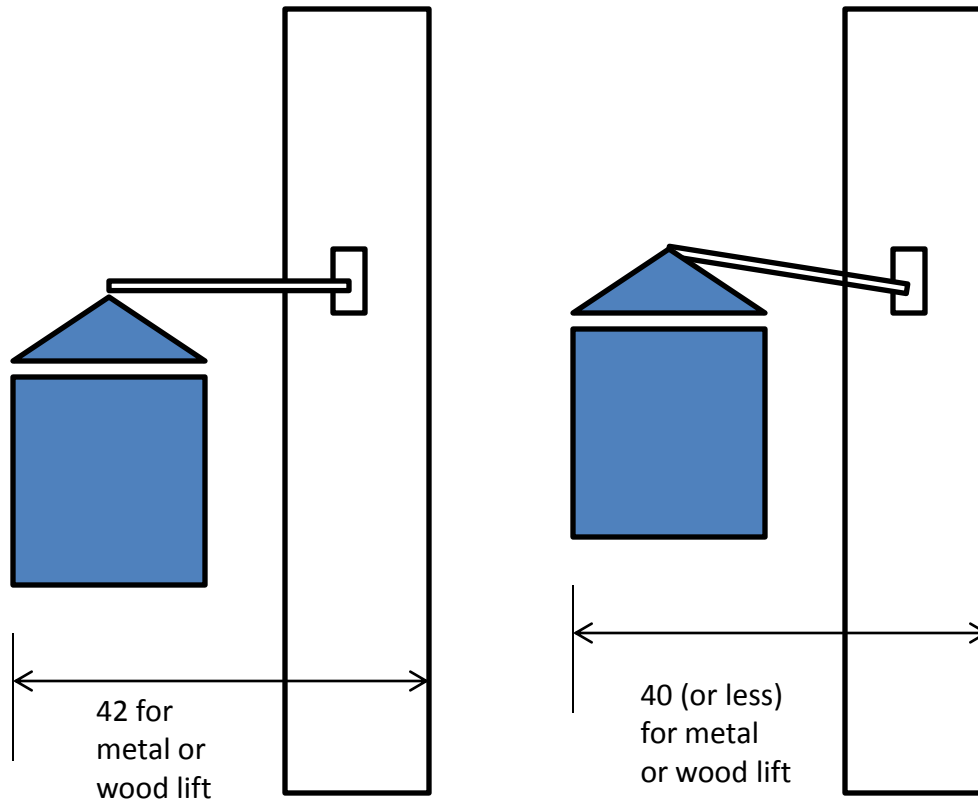

All lifts can have lower limits set to decrease encroachment if necessary



STORAGEMOTION^{INC.}

Different Mounting constraints

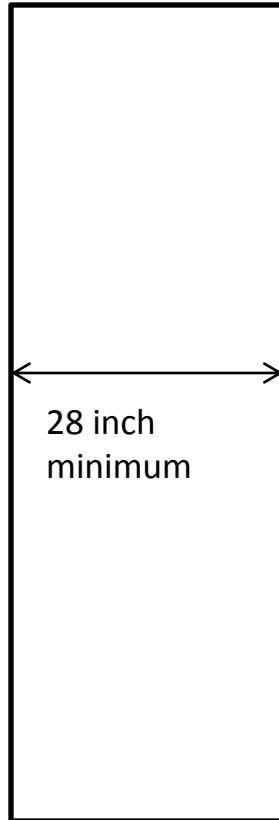

Any mounting dimension less will require extensive customization

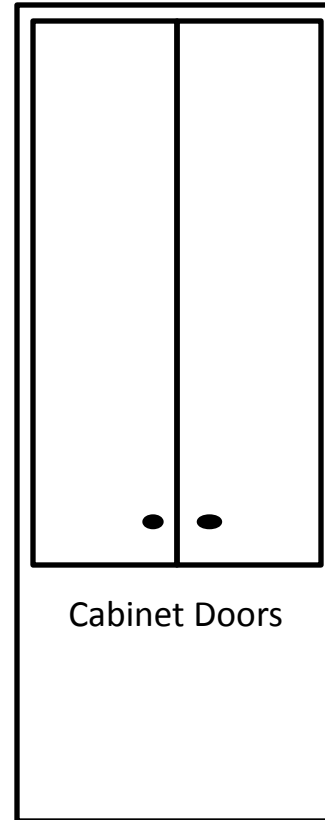

All lifts have minimum 7/8 inch clearance for hinges

Wireless wall switch should be placed behind the cabinet doors



STORAGEMOTION^{INC.}
Electrical

6 foot motor cord
comes out the left
side of motor tube

Electrical Outlet can
be placed at top of
closet or unit can be
hardwired by an
electrician

2 amps 120 volt

Motor is rated for
intermittent use

